

## Logistics Plan

### LEGEND:

SITE  
ENTRANCE

AREA OF WORK

STAGING

SAFETY  
FENCING

GENERAL ALTERATIONS AT MULLEN GYMNASIUM  
TAFT UNION HIGH SCHOOL  
701 WILDCATE WAY TAFT, CA 93268





24-  
ATTACHMENT TO  
FORM NO. 09-B  
Phasing Plan

AREA OF WORK  
Start June 4th, 2026  
Complete by July 17th, 2026

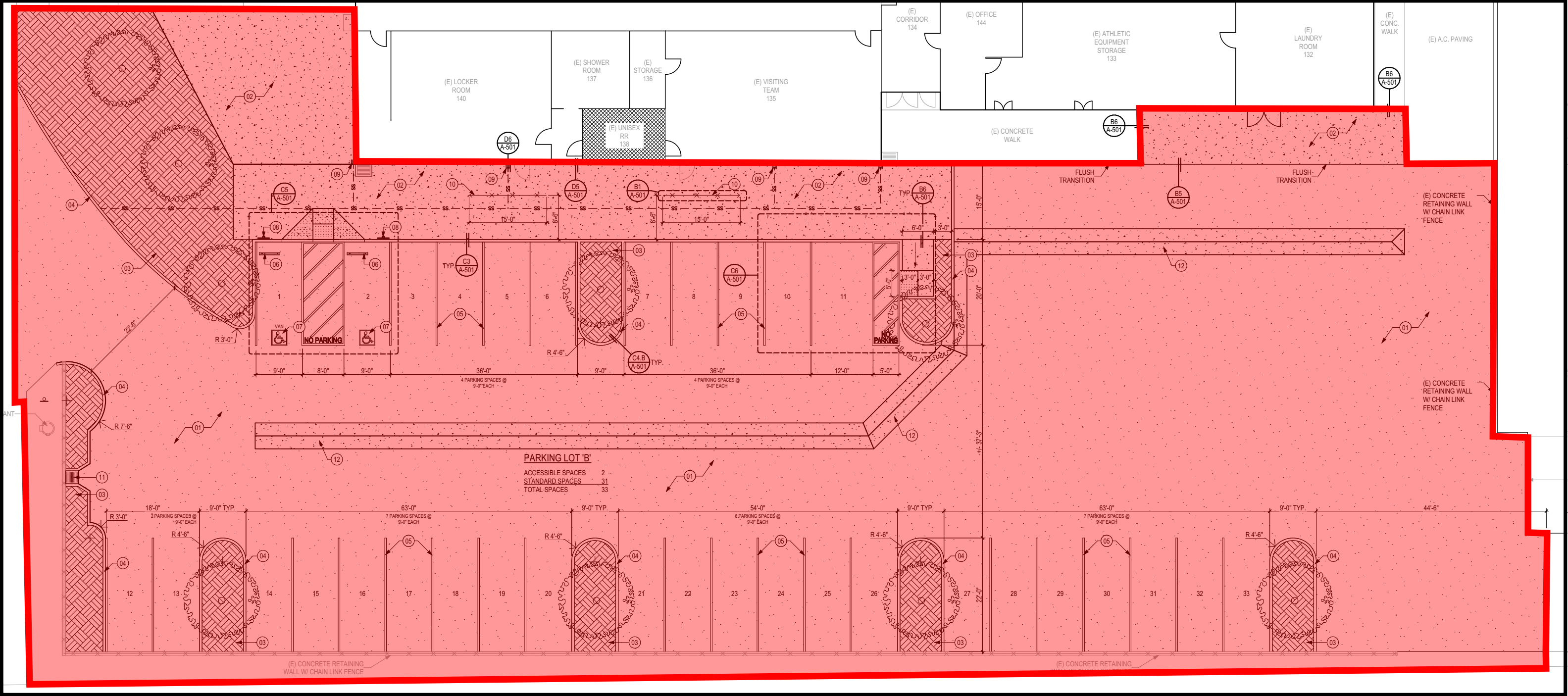

GENERAL ALTERATIONS AT MULLEN GYMNASIUM  
TAFT UNION HIGH SCHOOL  
701 WILDCATE WAY TAFT, CA 93268



## Phasing Plan

AREA OF WORK  
Completed by July 13th, 2026

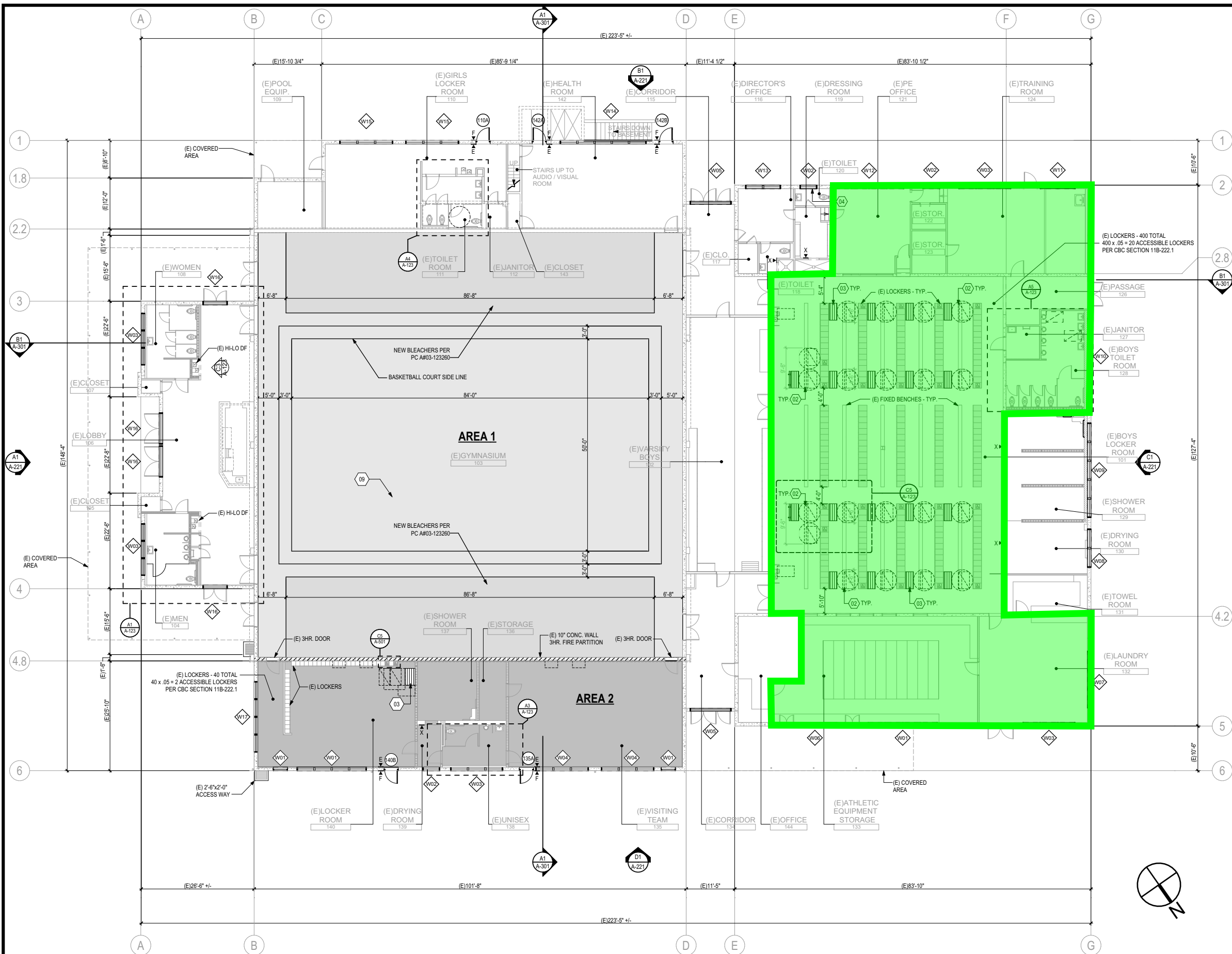

GENERAL ALTERATIONS AT MULLEN GYMNASIUM  
TAFT UNION HIGH SCHOOL  
701 WILDCATE WAY TAFT, CA 93268

**PRIME BIDDER CERTIFICATION OF DISABLED VETERAN  
BUSINESS ENTERPRISE PARTICIPATION**

*To be completed by the Prime Bidder*

PAGE 1 OF 2

<b>PART I – IDENTIFICATION INFORMATION</b>		
BIDDER'S NAME	BUSINESS ADDRESS	TELEPHONE NUMBER
SCHOOL DISTRICT	COUNTY	APPLICATION NO.
<p><b>PART II – METHOD OF COMPLIANCE WITH DVBE PARTICIPATION GOALS</b> – Include this form and any other applicable documents listed in this table with your bid/proposal. Read the three columns in the table below as sentences from left to right. Check the appropriate box to indicate your method of committing the contract dollar amount.</p> <p><b>NOTE:</b> <i>Architectural, engineering, environmental, land surveying or construction management firms must indicate their method of compliance by marking the appropriate box A, B, C, or D after selection by the District and before the contract is signed.</i></p>		
<b>YOUR BUSINESS ENTERPRISE</b>	<b>AND YOU</b>	<b>AND YOU</b>
<b>A.</b> <input type="checkbox"/> <i>is Disabled Veteran owned and your forces, will perform at least 3 percent of this contract</i>	<i>will include a copy of your DVBE letter from the Office of Small Business and Disabled Veteran Business Enterprise Services (OSDS).</i>	
<b>B.</b> <input type="checkbox"/> <i>is Disabled Veteran owned <b>but is unable</b> to perform the 3 percent of this contract with your forces</i>	<i>will use DVBE subcontractors/ suppliers to bring the contract participation to at least 3 percent</i>	<i>will include a copy of each DVBE's letter from OSDS (including yours, if applicable).</i>
<b>C.</b> <input type="checkbox"/> <i>is <b>not</b> Disabled Veteran owned</i>	<i>will use DVBE subcontractors/ suppliers for at least 3 percent of this contract</i>	
<b>D.</b> <input type="checkbox"/> <i>is unable to meet the required participation goals</i>	<i>will complete a Good Faith Effort to obtain DVBE participation</i>	<i>will include the Prime Bidder's Good Faith Effort Worksheet.</i>

**Note:** An Office of Small Business and Disabled Veteran Business Enterprise Services (OSDS) letter must be attached for each DVBE participating in the contract. The DVBE letter is obtained by application through the OSDS and must be provided at the time of bid opening. If the letter is not provided, the bid may be deemed nonresponsive and may be ineligible for award of the contract.

*Continued on reverse side*

**PART III – DVBE DOLLAR PARTICIPATION OF BID/PROPOSAL** – *Architectural, engineering, environmental, land surveying or construction management firms complete this part **after** selection by the district and before the contract is signed.*

*Show deductive alternate(s) in parenthesis. For more alternates/base bids, use a separate page to show items.*

- A. If your business enterprise is a DVBE, list in the appropriate column the total dollar amount of your bid to be performed by your own participation.
- B. List all your DVBE subcontractors/suppliers. Enter in the appropriate column the dollar amount for each of your subcontractors/suppliers.
- C. Enter the total of Lines A and B for each column.
- D. Enter the dollar amount of the bid/proposal to be performed by **non-DVBE** firms. Note: This line is the sum of the prime and subcontractor(s) **non-DVBE** dollar participation.
- E. Enter the sum of the column totals from Line C and Line D. Note: Please be aware that the final determination of DVBE compliance is made based on the contract amount resulting from the district's acceptance or rejection of alternates.

	<b>BASE BID/PROPOSAL</b>	<b>ALTERNATE #1</b>	<b>ALTERNATE #2</b>	<b>ALTERNATE #3 OR BASE BID B</b>	<b>ALTERNATE #4 OR BASE BID C</b>	<b>ALTERNATE #5 (Modernization or Reconstruction Only)</b>
A. Prime Bidder, <i>if DVBE (own participation)</i>	\$	\$	\$	\$	\$	\$
B. DVBE Subcontractor or Supplier						
1.						
2.						
3.						
4.						
C. Subtotal (A & B)						
D. Non-DVBE						
E. Total Bid						

## PRIME BIDDER GOOD FAITH EFFORT WORKSHEET

*This worksheet is to be used to assist the Prime Bidder in meeting the 3% DVBE participation goal*

PAGE 1 OF 2

BIDDER'S NAME	BUSINESS ADDRESS	CONTACT PERSON
TELEPHONE NUMBER	OWNER	COUNTY

### GENERAL INSTRUCTIONS:

This worksheet is to be used to assist you in meeting the 3 percent DVBE participation goal. If specific information is not provided for Parts I through III, you do not meet the test of the "Good Faith Effort" and cannot so certify. If you are qualifying based on a "Good Faith Effort" you must include this form with your bid/proposal to the Owner.

### PART I – CONTACTS

To identify DVBE subcontractors/suppliers for participation in your bid/proposal, contact must be made with each of the following categories. It is recommended that you contact several DVBE organizations.

CATEGORY	TELEPHONE NUMBER	DATE CONTACTED	PERSON CONTACTED
1. Owner			
2. Office of Small Business and Disabled Veteran Business Enterprise Services (OSDS). OSDS provides assistance locating DVBE's at <a href="https://caleprocure.ca.gov/pages/PublicSearch/suppliersearch.aspx">https://caleprocure.ca.gov/pages/PublicSearch/suppliersearch.aspx</a>	(916) 375-4940		
3. DVBE Organizations ( <i>List</i> ):			
4. Write "recorded message" in this column, if applicable.			

**PART II – ADVERTISEMENTS** You must make at least two (2) advertisements, one (1) in a paper that focuses on DVBE and one (1) in a trade paper. Advertisements should be published at least 14 days prior to bid/proposal opening; if you cannot advertise 14 days prior, advertise as soon as possible and provide an explanation. (Advertisements must be published in time to allow for a reasonable response). Advertisements must include that your firm is seeking DVBE participation, the project name and location, your firm's name, your firm's contact person, and phone number.

*Attach copies of advertisements to this form.*

FOCUS/TRADE PAPER NAME	CHECK ONE		DATE OF ADVERTISEMENT
	TRADE	FOCUS	

**PART III – DVBE SOLICITATIONS** List DVBE subcontractors/suppliers that were invited to bid. Use the following instructions to complete the remainder of this section (read the three columns as a sentence from left to right). If you need additional space to list DVBE solicitations, please use a separate page and attach to this form.

IF THE DVBE.....	THEN.....	AND.....		
Was selected to participate	Check "yes" in the "SELECTED" column, include the applicable dollar amount in Part III of the Prime Bidder Certification	Include a copy of their DVBE letter from OSDS.		
Was <b>not</b> selected to participate	Check "no" in the "SELECTED" column	State why in the "REASON NOT SELECTED" column.		
Did not respond to your solicitation	Check the "NO RESPONSE" column			
DISABLED VETERANS BUSINESS ENTERPRISES CONTACTED	SELECTED		REASON NOT SELECTED <i>This section must be completed</i>	NO RESPONSE
	YES	NO		

#### IMPORTANT NOTE:

Please be aware that certification of the "Good Faith Effort" may only be made if you fully complete Parts I, II, and III on both sides of this form. A copy of this form must be retained by you and may be subject to a future audit.

#### CERTIFICATION

I, \_\_\_\_\_ certify that I am the bidder's Chief Executive Officer and that I have made a diligent effort to ascertain the facts with regard to the representations made herein. In making this certification, I am aware of Section 12650 et seq. of the Government Code providing for the imposition of treble damages for making false claims.

SIGNATURE OF CHIEF EXECUTIVE OFFICER

DATE